

# ELECTRIC SALAMANDERS WITH REMOVABLE GRID

<b>Description</b>	<b>E600</b>	<b>E800</b>
<b>Salamanders</b>	<b>V02228</b>	<b>V02683</b>
<b>Description</b>	<b>E1</b>	<b>E2</b>
<b>Salamanders</b>	<b>V00257</b>	<b>V00258</b>



## INSTALLER'S INSTRUCTIONS

# SUMMARY

<b>INSTALLER'S INSTRUCTIONS .....</b>	<b>1</b>
<b>1. INSTALLATION .....</b>	<b>3</b>
1.1. GENERAL POINTS .....	3
1.2. HANDLING.....	3
1.3. INSTALLATION .....	3
1.4. DATA PLATE.....	4
<b>2. POWER CONNECTION.....</b>	<b>4</b>
2.1. CHECKS BEFORE PROCEEDING.....	4
2.2. CONNECTING THE APPLIANCE TO THE ELECTRIC NETWORK.....	5
2.3. CHECKS AFTER CONNECTION .....	5
2.4. ADAPTING THE APPLIANCE TO THE VARIOUS ELECTRICAL SUPPLIES VOLTAGE .....	5
<b>3. WIRING DIAGRAMS.....</b>	<b>8</b>
<b>4. BASIC SPARE PARTS LIST .....</b>	<b>11</b>

## 1. INSTALLATION

### 1.1. General points

Installation must be undertaken in compliance with the following instructions and with local codes and bylaws. Ensure you have a suitable and sufficient risk assessment in place.

**The user manual must be given to the user after installation.**

### 1.2. Handling

It is imperative to leave the appliance on its wooden pallet for handling on site until the final installation.

Unpack and check the appliance for damage upon receipt.

In case of damage, mark delivery note accordingly and immediately (within 48 hours) notify the carrier by registered mail with acknowledgement of receipt. Notify your installer.

### 1.3. Installation

The appliance must be installed under a suitable mechanical extraction hood, close to the electric supply.

If the apparatus is to be installed against a wall or partition, near a piece of furniture or decorative borders, it is recommended that these are made of fireproof material.

If this is not the case, they must be protected by an approved fireproof, insulating material.

If in doubt of fireproof construction of adjacent walls, distance to combustible material shall be no less than 10 cm.

Remove all plastic protection.

Install the appliance in the kitchen.

## Warnings



### SERVICING

**Any technical action on an appliance must be undertaken by a qualified technician.**

**The appliance will have to be isolated from the electrical supply for the duration of the work.**

When the appliance is ready for use, ensure the users know how to use it properly. (Please see the user's manual).

WARRANTY: The warranty is mentioned in our conditions of sale.

This warranty does not cover damage due to faulty installation, misuse or inadequate maintenance.

#### 1.4. Data plate

Each appliance has its own data plate. Transfer all the information of the data plate to the part of the user's manual (see the last page of the User's Manual)

This will ease the communication between you and your client for better service.



## 2. POWER CONNECTION



### Warnings

The appliance must be earth wired.  
It is dangerous to connect the appliance unless it is earthed.  
We cannot be held responsible for accidents due to non-existent or incorrect earth link connection.

- **Fixed appliance:**

Check that the electric network is equipped with all-pole circuit breakers having a cross section of 3.5 mm, and complies with the European Standard EN 60335-1 dated of May.

- **Appliance:**

The appliance being connected to a cable fitted with an electrical plug, the socket should be accessible at all times.

- **WARNING:**

Use a standardized cable (245 IEC 57 or 245 IEC 66) or other approved cable with the same characteristics.

All controls and checks below are done when the appliance is switched off and cold.

#### 2.1. Checks before proceeding



Before connecting the apparatus, check that:

- The electrical voltage of the supply is compatible with the voltage of the apparatus (see data plate and § 5 ),
- The cable is fixed properly,
- The connections are tight enough,
- The section of the cable is of correct size according to the voltage of the apparatus.

## 2.2. Connecting the appliance to the electric network

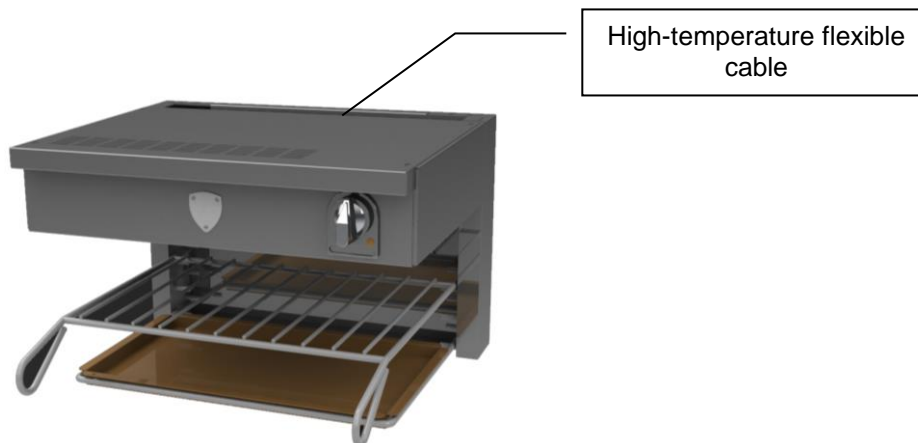

The appliance is delivered with a high-temperature flexible cable. You can access the cable through the back of the appliance. Connect the appliance to the main electrical supply.

**Before reassembling the parts, check the electrical equipment is properly insulated (cable).**

## 2.3. Checks after connection

- After connection, ensure that:
  - The appliance is earth wired,
  - The electric equipment is well isolated from the rest of the equipment,
  - The appliance is in good working order (thermostat, etc.).

STARTING UP: Please see the user's manual, section "Starting up."

## 2.4. Adapting the appliance to the various electrical supplies voltage

<i>Voltages available</i>	⇔				
<i>Voltages of appliance</i>	↓	1~230V + E	3~230V + E	3~400V + E	3~400V+N+E
<b>Salamander E600 - E800</b>				<b>S</b>	
<b>Wiring diagrams #</b>				<b>TR0058</b>	
<b>Salamander E1</b>				<b>S</b>	
<b>Wiring diagrams #</b>				<b>SE0045/00</b>	
<b>Salamander E2</b>				<b>S</b>	
<b>Wiring diagrams #</b>				<b>SE0046/00</b>	

A → Coupling possible B → Please consult Charvet C → Coupling impossible D → No voltage available S → Standard

## Electric salamander 600

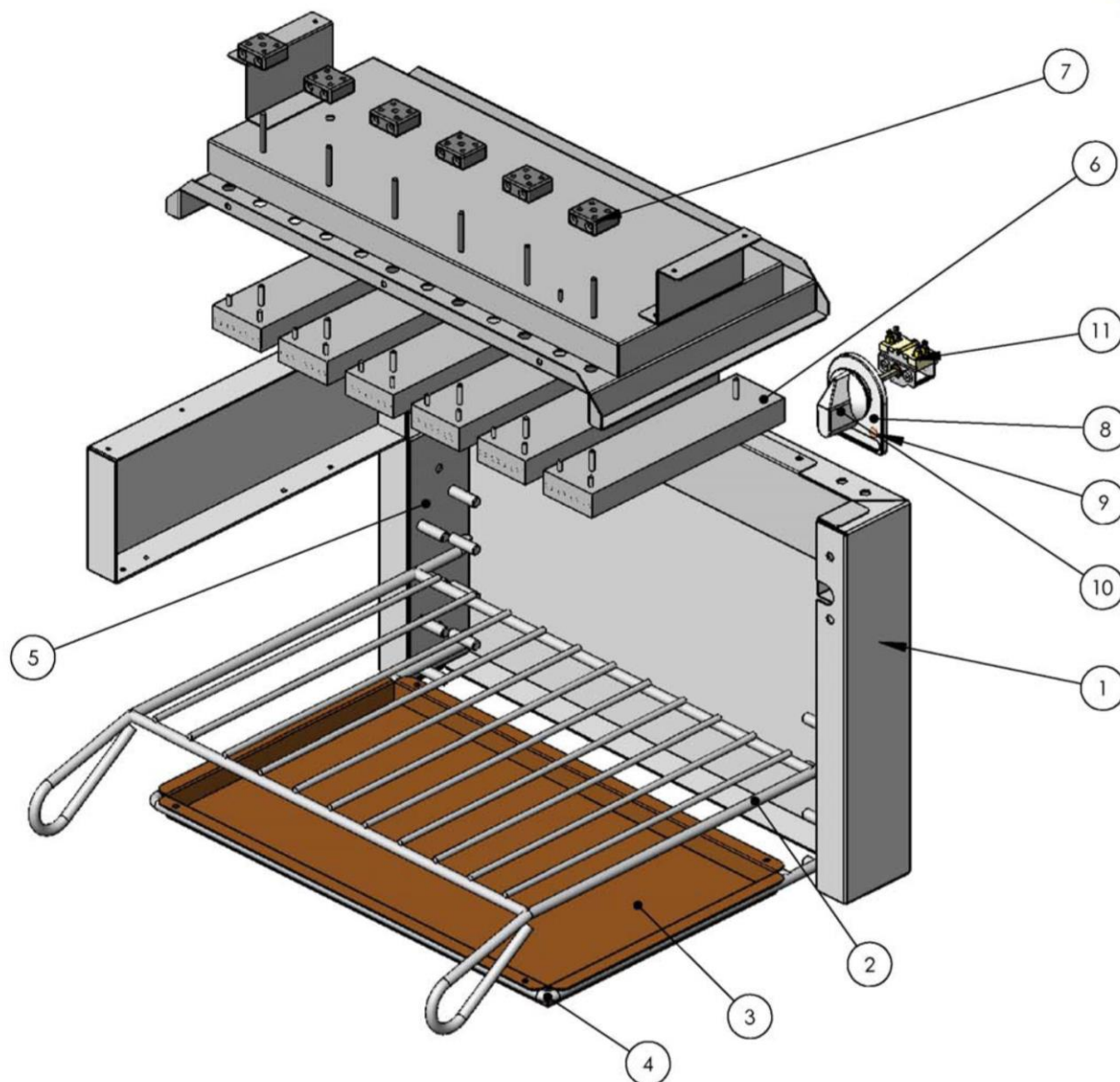

No	Code	Quantity	Description
1	100737	1	Stainless steel frame
2	505019	1	Grid
3	500606	1	Enameled tray
4	Div0219	1	U-shaped tray support
5	100374/100378	2	Support bars for grid
6	Ele0263	6	Quartz heating element 500W 230V
7	Ele0005	6	2-pole domino 16mm <sup>2</sup>
8	-	1	Panel with control symbol markings
9	Ele0434	1	Orange indicator 230/400V
10	-	1	Control knob
11	Ele0083	1	Tripolar switch

## Electric salamander 800

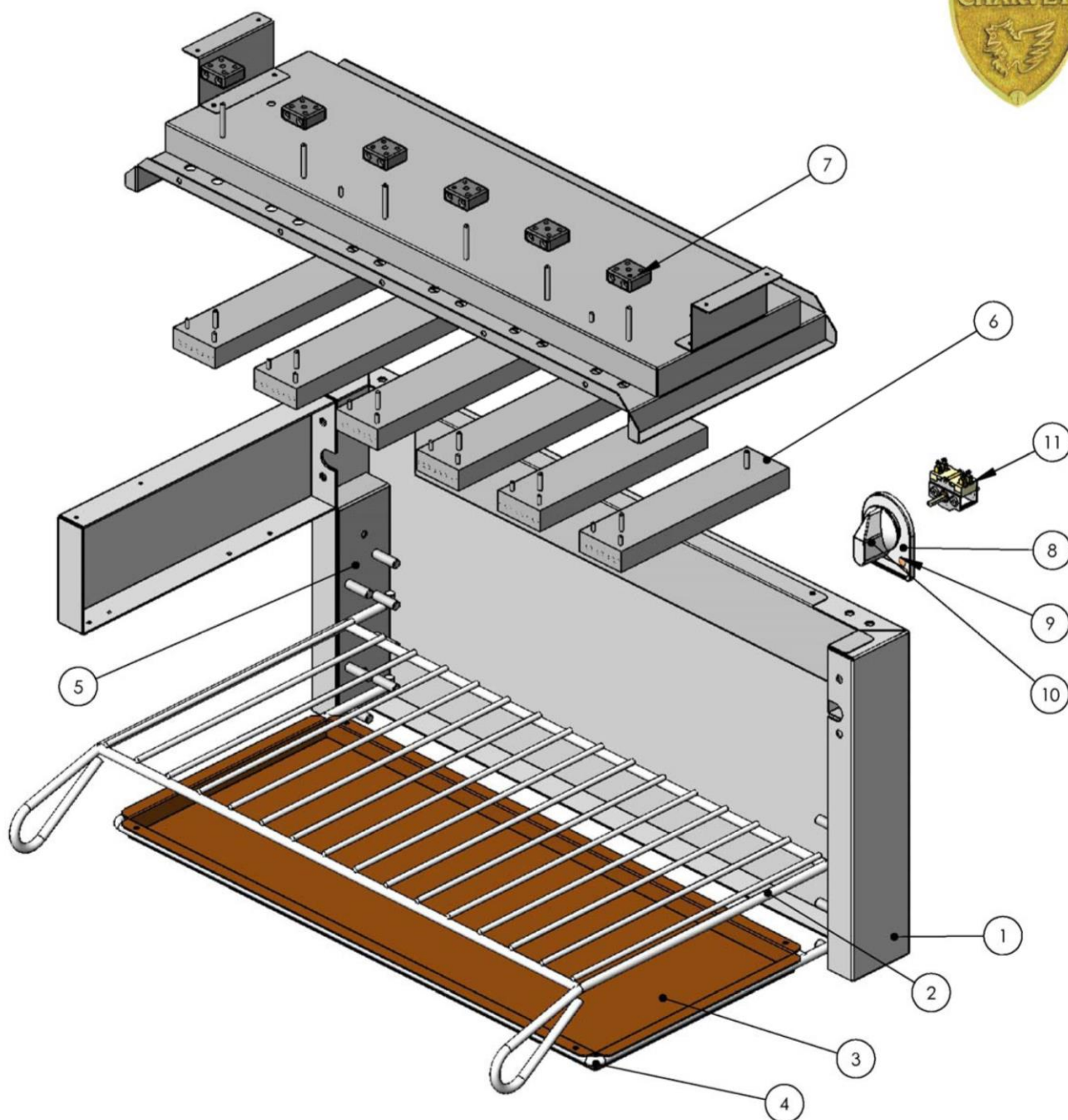

No	Code	Quantity	Description
1	100738	1	Stainless steel frame
2	505019	1	Grid
3	500603	1	Enameled tray
4	Div0220	1	U-shaped tray support
5	100374/100377	2	Support bars for grid
6	Ele0264	6	Quartz heating element 750W 230V
7	Ele0005	6	2-pole domino 16mm <sup>2</sup>
8	-	1	Panel with control symbol markings
9	Ele0434	1	Orange indicator 230/400V
10	-	1	Control knob
11	Ele0083	1	Tripolar switch

## 3. WIRING DIAGRAMS

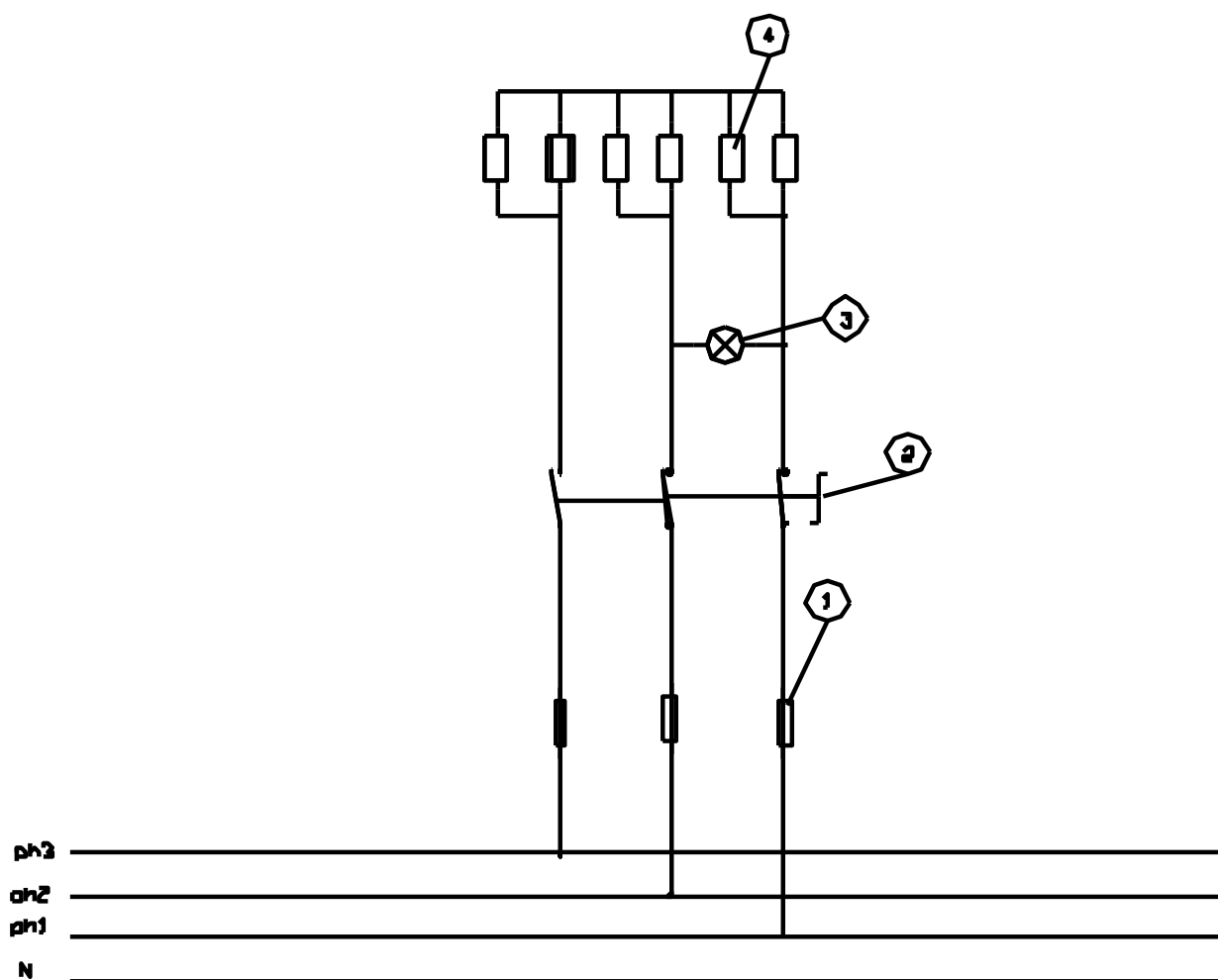
**NOMENCLATURE: SALAMANDERS E600-E800 TR005 3~400V+PE**

Marks	Code	Description	Quantity
01		Fuses for electric supply	3
02	Ele0083	Tripolar switch	1
03	ELE0434	Orange indicator 230V / 400V	1
04	Ele0263	Heating element 500W - E600	6
05	Ele0264	Heating element 750W - E800	6



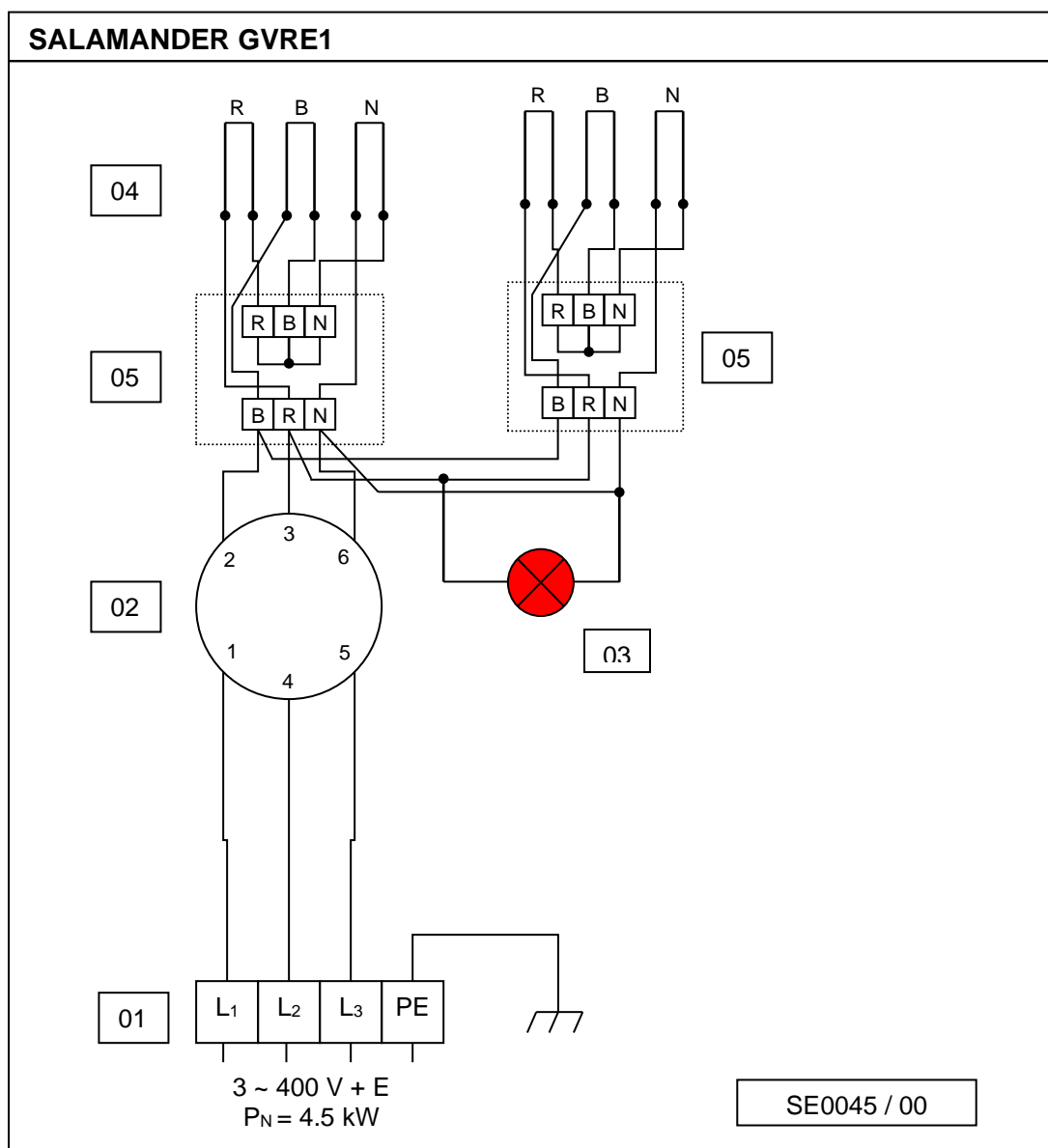

**NOMENCLATURE: SALAMANDER GVRE1 (Wiring diagram: SE0045/00)**



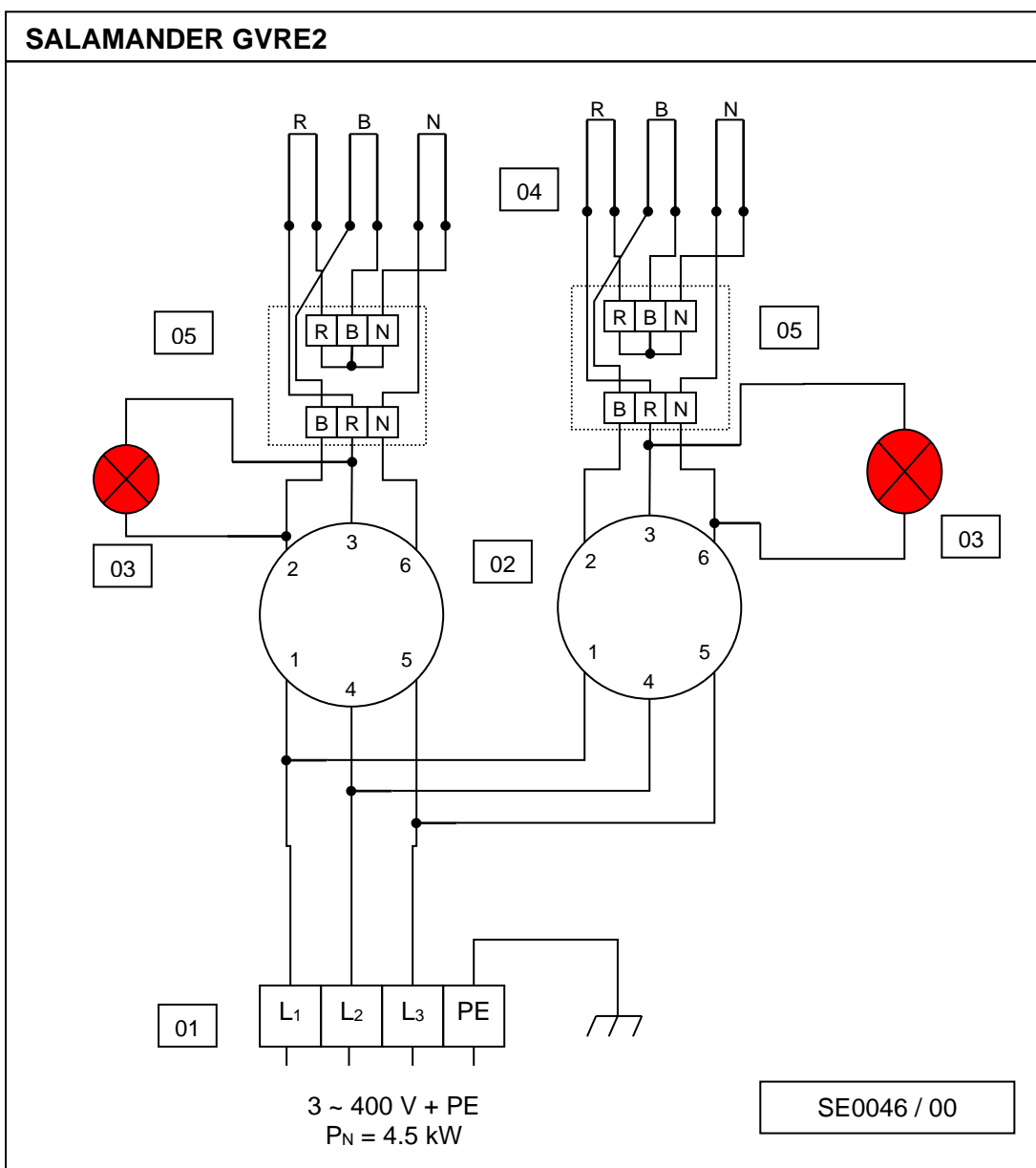





Mark	Code	Description	Quantity
01	02468A	10 mm <sup>2</sup> terminal (brand: Viking)	3
01	03575A	10 mm <sup>2</sup> Earth terminal (brand: Viking)	1
02	02097A	Switch	1
03	F14551	Red indicator	1
03		Bulb	1
04	02060A	Heating element 750 W, 230 V	6

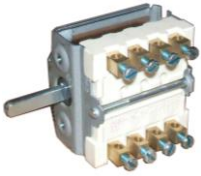

**NOMENCLATURE: SALAMANDER GVRE2 (Wiring diagram: SE0046 / 00)**

Mark	Code	Description	Quantity
01	02468A	10 mm <sup>2</sup> terminal (brand: Viking)	3
01	03575A	10 mm <sup>2</sup> Earth terminal (brand: Viking)	1
02	02097A	Switch	2
03	F14551	Red indicator	2
03		Bulb	2
04	02060A	Heating element 750 W, 230 V	6

## 4. BASIC SPARE PARTS LIST

Description / Code	Photograph	Description / Code	Photograph
<b>Salamander E600/ E800</b>			
Tripolar switch Ele0083		Orange indicator 230/400V ELE0434	
Quartz heating element E800 750W Ele0264  E600 500W Ele0263		2-pole domino Ele0005	
<b>Salamander E1 / E2</b>			
Switch 02097A		Bulb 400 V 02142A	
Red indicator F14551		Heating element 750 W 230 V 02060A	

# ELECTRIC SALAMANDERS WITH REMOVABLE GRID

<b>Description</b>	<b>E600</b>	<b>E800</b>
<b>Salamanders</b>	<b>V02228</b>	<b>V02683</b>
<b>Description</b>	<b>E1</b>	<b>E2</b>
<b>Salamanders</b>	<b>V00257</b>	<b>V00258</b>



## USER'S MANUAL

# SUMMARY

<b>USER'S MANUAL .....</b>	<b>1</b>
<b>1. INTRODUCTION .....</b>	<b>3</b>
<b>2. PRIOR TO STARTING UP .....</b>	<b>3</b>
<b>3. STARTING UP .....</b>	<b>3</b>
<b>4. SWITCHING OFF .....</b>	<b>4</b>
<b>5. MAINTENANCE .....</b>	<b>4</b>

## 1. INTRODUCTION

- A) Our equipment is for professional use only and must be used by qualified staff.
- B) The equipment must be installed in compliance with local codes and bylaws. It must be installed in a kitchen equipped with an adequately sized mechanical extraction system.
- C) Appliances may be installed side by side or against walls of non combustible material. Distance to combustible material shall be no less than 10 cm.
- D) It is imperative to call for a qualified engineer for all new installations or modifications of existing equipment.
- E) **WARRANTY:** *The warranty is mentioned in our conditions of sale. Only a qualified engineer certifies the validity of the warranty. This warranty does not cover damage due to faulty installation, misuse or inadequate maintenance.*

### Warnings:

**Our equipment must not be cleaned with water under pressure or be subjected to a deluge of water splashes.**

**Avoid water splashes on the heating elements.  
Never clean the heating elements with a wire brush.**

**Wait until the heating elements have cooled down before cleaning them. Major risks of burns!**

## 2. PRIOR TO STARTING UP

- a) Clean carefully the salamander before the first use.

Remove all plastic protection that wraps the apparatus and accessories.

- b) Clean with a wet sponge and dry.

## 3. STARTING UP

The appliance is ON:

- Turn the control knob to position "1" (E600 / E800): the orange indicator is illuminated.
- Turn the control knob to the desired position (E1 / E2) (vault / mild steel base / vault & mild steel base – low (doux) / vault & mild steel base – high (fort))

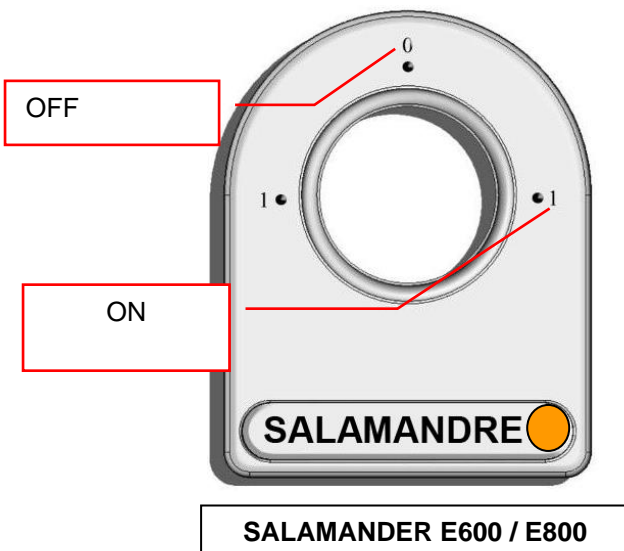

**WARNING:**

*The grid and juice drawer may be very hot. Take all necessary precautions to handle these parts.*

**4. SWITCHING OFF**

Bring the thermostat knob back to the "0" position (STOP).

Clean carefully the enameled tray and grid after each use to remove all residues.

When work is over for the day, cut power off at the mains.

**5. MAINTENANCE**

**Cleaning of the stainless steel surfaces:**

Wash with a sponge in soapy water (or any other neutral cleaning product).

*Do not use bleach or any other acidic product – even well diluted.*

For the tops, use a nylon scouring pad if necessary. Always go with the grain.

After each cleaning, rub with a greased cloth or kitchen paper.

Finger marks can be removed with a cloth dabbed with alcohol.

**Cleaning the grid and enameled tray:**

They can be cleaned with a sponge in soapy water, rinsed, and dried.

*For best results, have your equipment serviced and cleaned on a regular basis by a qualified installer.*





***WARNING: Factory-sealed components must be serviced by neither installer nor user. Only a qualified electrician should replace the parts.***

Contact the supplier to replace the faulty parts for further use.

**The manufacturer and the installer cannot be held responsible if the user neglects to ask for assistance in case of breakdown.**

TRANSFER below information written on the data plate of your apparatus.

This will ease the communication between you and your installer, and will help you with maintenance problems and spare parts.

	<b>CHARVET S.A.</b>		
	<b>38850 CHARAVINES</b>		
Réf.	<input style="width: 100%;" type="text"/>		
Code:	<input style="width: 50%;" type="text"/>	Type:	<input style="width: 50%;" type="text"/>
N°FC:	<input style="width: 50%;" type="text"/>		<input style="width: 50%;" type="text"/>
N°OF:	<input style="width: 50%;" type="text"/>	Rep.	<input style="width: 50%;" type="text"/>
Cat.	<input style="width: 50%;" type="text"/>	<input style="width: 50%;" type="text"/>	
Gaz	<input style="width: 50%;" type="text"/>	<input style="width: 50%;" type="text"/>	
P (mbar)	<input style="width: 50%;" type="text"/>	<input style="width: 50%;" type="text"/>	
$\Sigma Q_n$ (kW)	<input style="width: 50%;" type="text"/>	<input style="width: 50%;" type="text"/>	
$\Sigma V_n$ (m <sup>3</sup> /h)	<input style="width: 50%;" type="text"/>	<input style="width: 50%;" type="text"/>	
$\Sigma M_n$ (kg/h)	<input style="width: 50%;" type="text"/>	<input style="width: 50%;" type="text"/>	
U	<input style="width: 50%;" type="text"/>	V	<input style="width: 50%;" type="text"/>
		Hz Ip	<input style="width: 50%;" type="text"/>
P	<input style="width: 50%;" type="text"/>	kW	<input style="width: 50%;" type="text"/>
	<input style="width: 100%;" type="text"/>		
<b>MADE IN FRANCE</b>			