



FULL MODULE UNIT
STEEL PLATE 4 ZONES 4 x 4 kW
ON OPEN BASE

Pro 1000

Summary

Energy : ELEC	Code : V02980	E1PCF4ZONE
----------------------	----------------------	-------------------

W x D x H (mm) : 1000 X 1000 X 900 mm
Voltage/Electrical P. : 3~400V+N+E/16 kW

Description of the device

General description

Chassis :

Support frame in AISI 304 stainless steel, thickness 15 to 30/10, assembled by high intensity electric welds.

Top :

Top (frame) in AISI 304 stainless steel, 30/10 thickness, with 55 mm front flanged edge and counter-fold.

Feet :

Feet, height 200 mm, in AISI 304 stainless steel tube, diameter 60 mm with adjustable bases (0 / + 30).

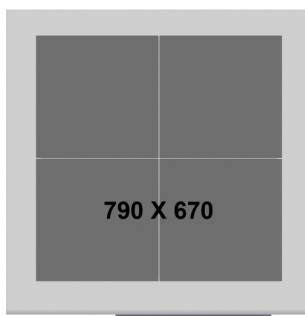

790 X 670

Top :

- . 4 heating zones under hotplates, in cast iron : 790 x 670 mm. Power : 4 x 4 kW - voltage : 3 ~ 400V + N + E.
- . switches with indicator lights.
- . integrated temperature limiters.

Basement :

- . open bay with removable 18-10 stainless steel floor in 2 parts.

Natural gas flow G20/20 :	-
Propane gas flow G31/37 :	-

Dimensions (mm) : 1000 X 1000 X 900 mm	Voltage/Electrical P. : 3~400V+N+E / 16 kW	Power : 16 kW	Weight : - kg
--	--	-------------------------	-------------------------

OPTIONS	CODE
Hinged door - for open base	V01577
S/S rear panel fitted in factory - W : 990 x H : 645 mm	V00887
S/S clip on plinth panels - H : 170 mm for standard legs	F02880
-	-
-	-
-	-
-	-
-	-
-	-

ACCESSORIES	CODE
-	-
-	-
-	-



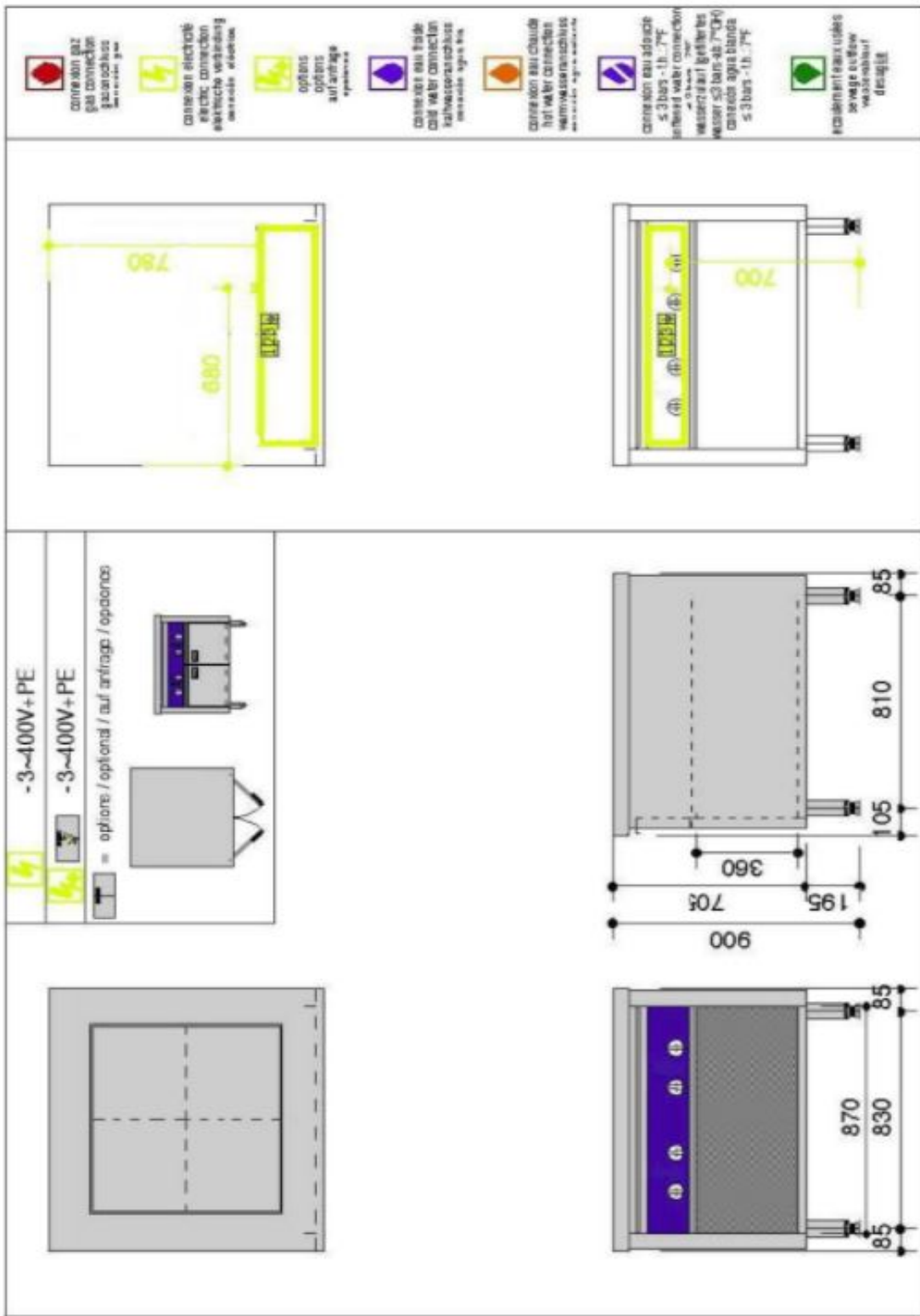

LES AUTHENTIQUES DE LA CUISSON

CHARVET

1170 rue principale - BP3 - 38850 Charavines - FRANCE

Tél: +33 (0)4 76 06 64 22 - info@charvet.fr

www.charvet.fr



YouTube

