



TILTING PAN

1~230V ELECTRIC MOTOR TILT

80 dm² / 160 liters

Pro 1000

Summary

Energy : ELEC

Code V02969

E1SBM80i

**W x D x H (mm) : 1500 X 1000 X 900
mm Power/Electrical P. : 3~400V+N
+E/ 22,5 kW**

Description of the device

General description

Frame :
Support frame in AISI 304 stainless steel, thickness 15 to 30/10, assembled by high intensity electric welds.

Above :
Top (frame) in AISI 304 stainless steel, 30/10 thickness, with 55 mm front flanged edge and counter-fold.

Foot:
Feet, height 200 mm, in AISI 304 stainless steel tube, diameter 60 mm with adjustable bases (0 / + 30).

Natural gas flow G20/20 :

-

Propane gas flow G31/37 :

-



Tilting pan :

- . 80 dm² tank : 18-10 stainless steel tank - 10 mm thick bottom.
- . 25/10 thick ferrule with beveled front face with large integrated spout.
- . interior side (mm) : L 1210 x D 680 x H 250 mm.
- . cover in 18-10 stainless steel, 15/10 thick, with stainless steel spring hinges for "keeping open"; handles in 18-10 stainless steel tube.
- . manual tilting by retractable flywheel, reduction gear and disengageable chain drive. Stainless steel spring assistance.

Heater :

- . armored resistors plated under tank.
- . control by energy metering device (0-100%) with off position - overheating safety indicator light by thermostat with automatic reset.
- . ergonomic arrangement of controls on vertical front cover on left side.

Dimensions (mm) :

1500 X 1000 X 900 mm

Power/Electrical P. :

3~400V+N+E/ 22,5 kW

Power :

22,5 kW

Weight :

- kg

OPTIONS

CODE

Supplement for a BIMETAL base - int/ext : AISI 304 2 mm thick /Steel : 8 mm thick	V02045
Equipment for a 24V remote control - contactor(s) not supplied	V00878
Terminal block for energy saver device - to regulate energy	V02427
Counter balanced lid - in all positions	V01197
Pan tilt safety cut out - stop heating when tilting	Included
Removable s/s drainage system - fitted in factory	V02494
S/S rear panel - W : 990/1490 x H : 645 mm	V01185
S/S clip on plinth panel - H : 170 mm for standard legs	V01191
Bain-marie adapter collar - for GN containers (not supplied)	V01159

ACCESSORIES

CODE

Mixer water tap CW/HW Ø 20x27 - swivel spout : 360° on the left side	V00563
Mixer water tap CW/HW Ø 20x27 - swivel spout : 180° on the left side	V01652
Hole cut to suit client's tap - tap supplied and fitted by client on the left side	V01292



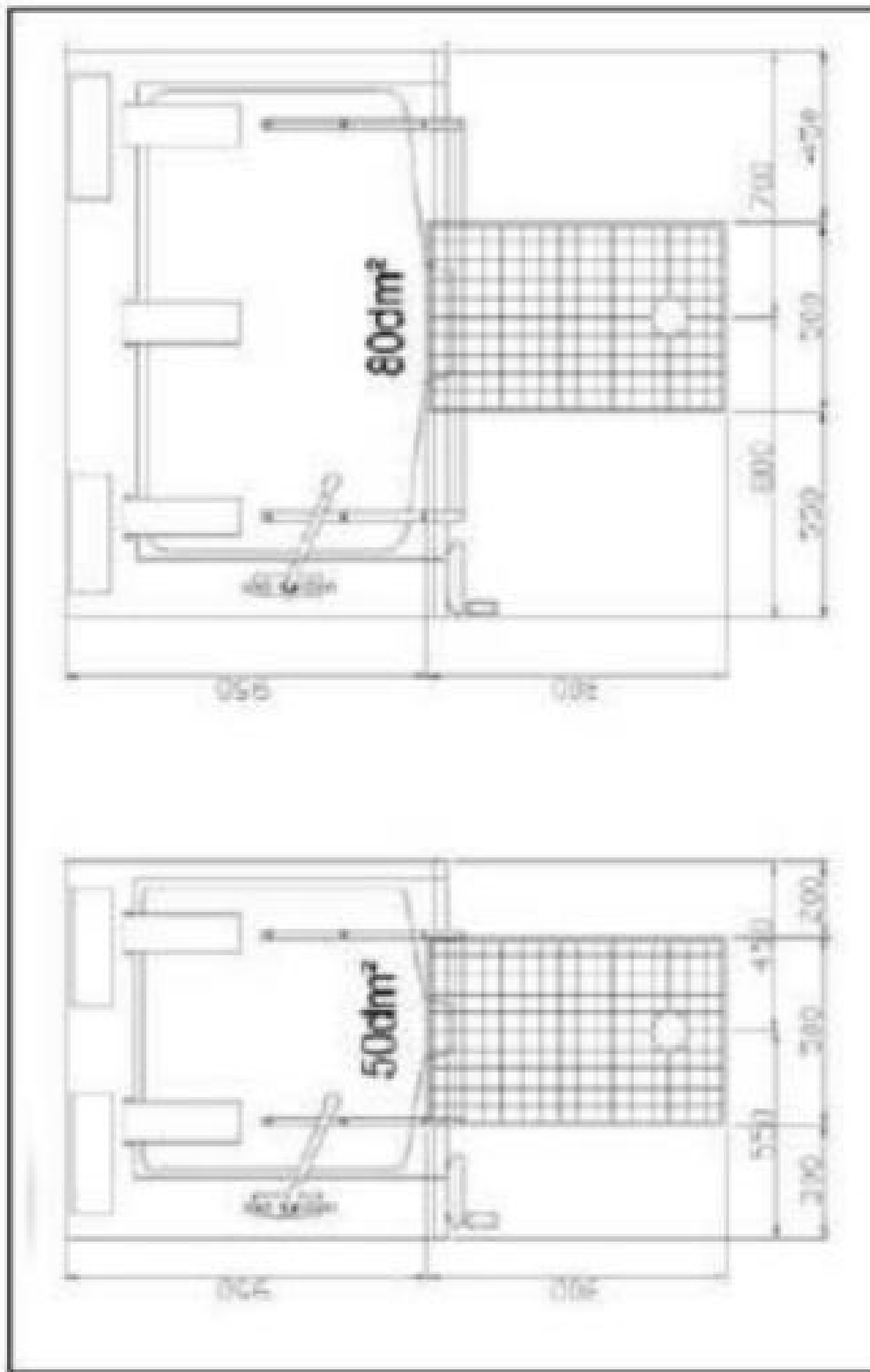

LES AUTHENTIQUES DE LA CUISSON

CHARVET

1170 rue principale - BP3 - 38850 Charavines - FRANCE

Tél: +33 (0)4 76 06 64 22 - info@charvet.fr

www.charvet.fr

