



HALF MODULE UNIT - BAIN-MARIE 1/1

OPEN BASE

Pro 900

Summary

Energy :

ELEC

Code :

V02002

Designation :

B-E1BME1/1

Dimensions (W x D x H) :

425 x 900 x 900 mm

Power : 1 kW (elec)

Voltage/Electric p. : 1~200V+E / 1

Weight :

DEVICE DESCRIPTION

General description

Chassis :

One-piece seam welded 18-10 stainless steel chassis, 1,5 to 3 mm thick, assembled by high intensity electrical welds and lower rear step for passage of cables and supply tubes.

Top :

Top (frame) in 18-10 stainless steel, 30/10 thickness, with 55 mm front flanged edge and plywood.

Base :

Feet, height 200 mm, in 18-10 stainless steel tube, diameter 60 mm with adjustable bases (0 / + 30).

Natural gas flow G20/20 :

Propane gas flow G31/37 :



Above :

- . GN1 / 1 water bain-marie:
- . GN 1/1 tank in 18-10 stainless steel with plume
- . Dimensions: W: 325 x D: 530 x H: 170 mm
- . Ball valve under the tank
- . Double perforated bottom in 18-10 stainless steel
- . Heating by 1 ~ 230V + T 1 kW resistors placed under the tank in a sealed box
- . Control and regulation by thermostat 30 - 110 ° C with off position - on indicator light

- . Removable cover in 18-10 stainless steel with handle
- Below:**

- . Open bay with removable 18-10 stainless steel floor

OPTIONS	CODE
Elec hot cupboard 4xGN2/1 in base 1~230V+E / 1,50 kW - therm. 0-30/110°C	V00825
Hinged doors for open base	V01980
Equipment for a 24V remote control contactor(s) not supplied	V00878
Drain tap to front 1 tank included in bridge unit/compulsory if hot	V01818
S/S rear panel fitted in factory W : 415 x H : 645 mm	V01181
Mixer water tap CW/HW Ø 15x21 swivel spout 360°	V01651
Mixer water tap CW/HW Ø 15x21 swivel spout 180°	V01292
Hole cut to suit client's tap - tap supplied and fitted by client	

ACCESSORIES	CODE
S/S clip on plinth panels H : 170 mm for standard legs	V01186



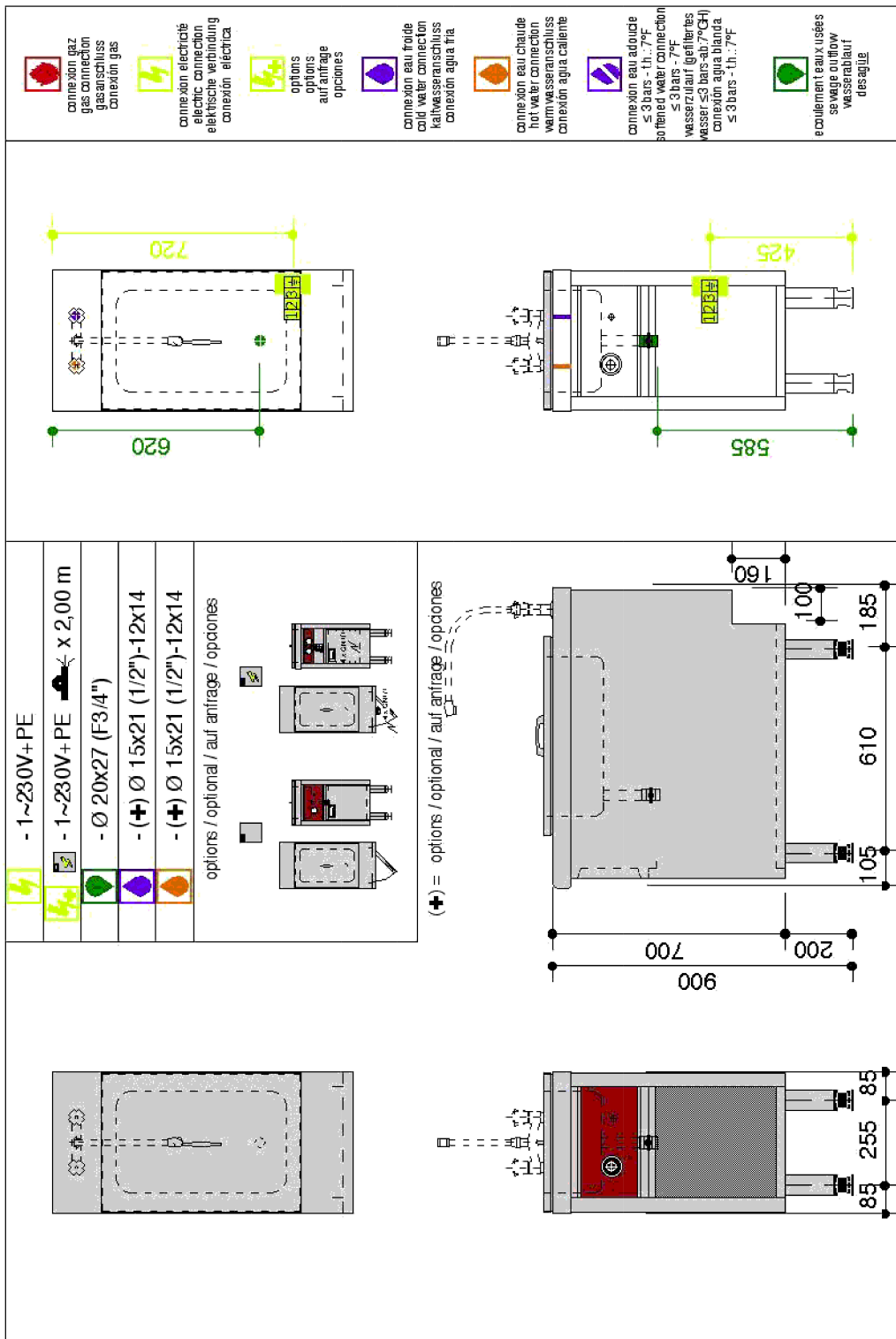

LES AUTHENTIQUES DE LA CUISSON

CHARVET

1170 rue principale - BP3 - 38850 Charavines - FRANCE

Tél: +33 (0)4 76 06 64 22 - info@charvet.fr

www.charvet.fr



YouTube

