



**1 x 100 L. / 80 KG/H + 1 STORAGE SILO - FRYER**  
WITH TRANSFER SYSTEM COLD ZONE

**TRANSFER 1 BASKET**

**Pro 1000**

**Summary**

**Energy :**

**ELEC**

**Code :**

**V00949**

**Designation :**

**E1FR100TRG**

**Dimensions (W x D x H) :**

**2000 x 1000 x 900 mm**

**Power : 60 kW (elec)**

**Voltage/Electric p. : 3~400V+N+E**

**Weight : 145 kg**

**Device description**

**General description**

**Chassis :**

Support frame in AISI 304 stainless steel, thickness 15 to 30/10, assembled by high intensity electric welds.

**Top :**

Top (frame) in AISI 304 stainless steel, 30/10 thickness, with 55 mm front flanged edge and counter-fold.

**Feet :**

Feet, height 200 mm, in AISI 304 stainless steel tube, diameter 60 mm with adjustable bases (0 / + 30).



Fryer : 100 liters

- . Boiler pan in 18-10 stainless steel 20/10 thickness with plume and cold zone.
- . Minimum-maximum oil level marks - retention grid removable at the bottom of the tank, drain valve chrome front.
- . Cover in stainless steel 18-10 thick. 10/15 and chrome handles.

Heater :

- . Shielded immersion heaters, power : 60 kW, voltage: 3 ~ 400V + N+T.
- . Switch, thermostat, indicator light - audible timer. Limiting thermostat with manual reset.

Transfer system :

- . Guide rails.
- . 1 transfer basket in 18-10 stainless steel with rollers. 18-10 stainless steel, and fully automatic fully opening bottom.

Right side silo :

- . Silo reception trolley : 4 swivel wheels without brakes. slides in 18-10 stainless steel profiles with clearance on the front for 4 GN1 / 1 French fries containers.

- . Round stainless steel handle length 890 mm.

Endowment :

- . 4 stainless steel GN1 / 1 x 150 mm containers. Important: fire safety
- Attention, do not juxtapose fryer (s)

**Natural gas flow G20/20 :**

**Propane gas flow G31/37 :**

**OPTIONS**

**CODE**

Terminal block for energy saver device - to regulate energy	V02427
Front electric socket - 1~230V+E /0,192 kW - fitted in factory	V02248
S/S rear panel fitted in factory - W : 490/990/1490 x H : 645 mm	V00887

**ACCESSORIES**

**CODE**

Additional trolley for storage silo - no container included	V00823
S/S clip on plinth panel - H : 170 mm for standard legs	F02880



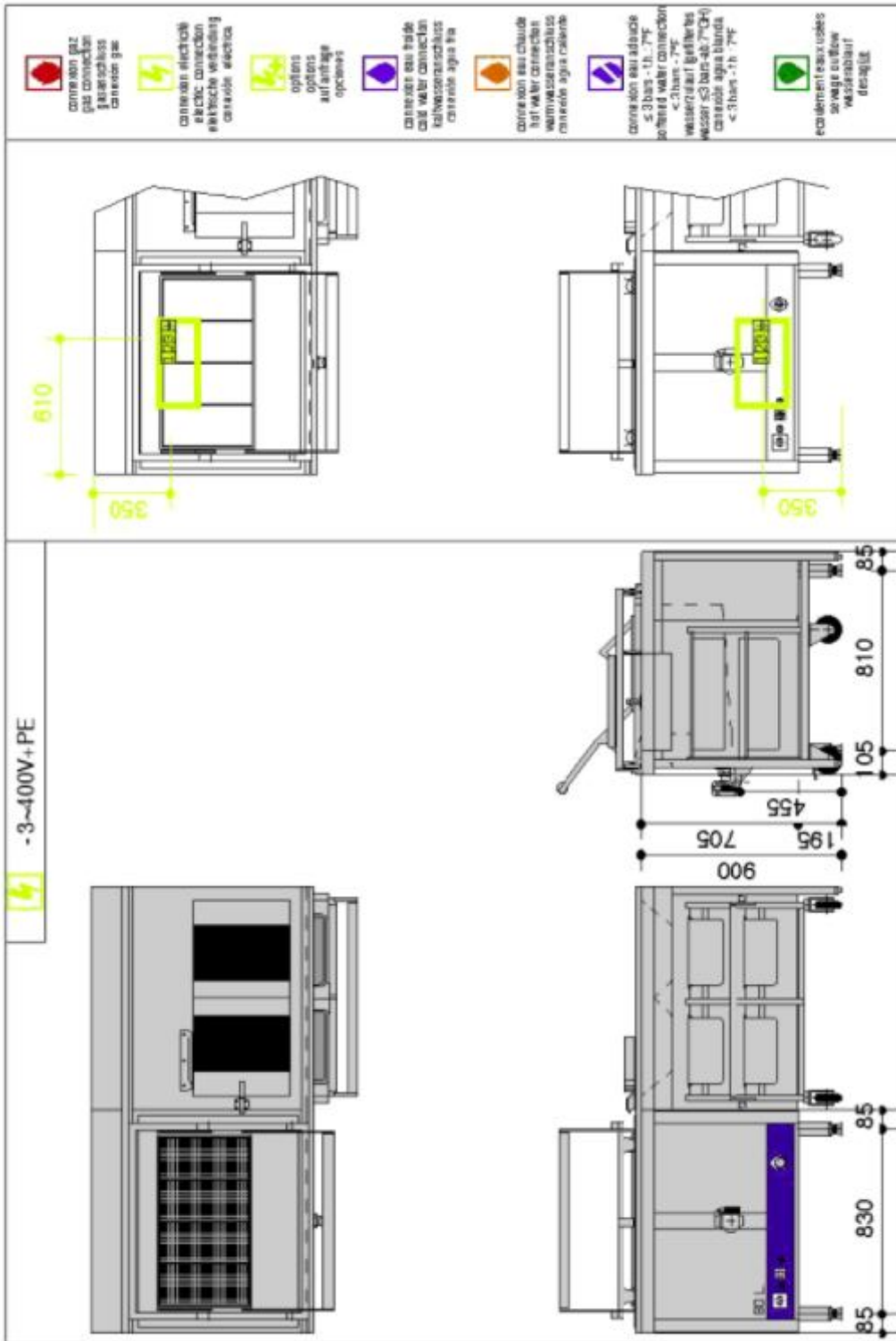

LES AUTHENTIQUES DE LA CUISSON

**CHARVET**

1170 rue principale - BP3 - 38850 Charavines - FRANCE

Tél: +33 (0)4 76 06 64 22 - info@charvet.fr

[www.charvet.fr](http://www.charvet.fr)



YouTube

