

INDUCTION WOK

OPEN CUPBOARD GN 1/1

GENERAL DESCRIPTION

- Chassis :

. One-piece seam welded stainless steel chassis 3 mm thick duct at the back.

- Top :

. AISI 430 Ti stainless steel top 3 mm thick with a 55 mm high edge and return to underside.

- General :

. AISI 304 side and front panels 1.2 mm thick.
 . Bright polished stainless steel corner column 1.2 mm thick.
 . Chrome coated dial indicator and knob.

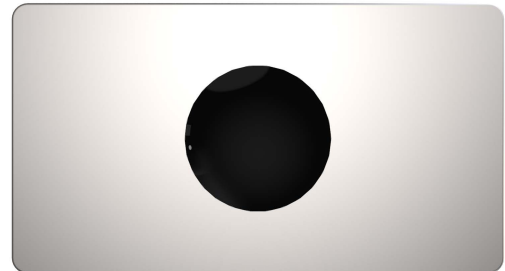

APPLIANCE DESCRIPTION

- Top :

. 1 induction wok.

- Induction wok :

. Concave vitroc ceramic bowl Ø 290 mm, rated 5 kW, shaped to accommodate induction wok pans (not supplied). . Potentiometer control switch with "STOP" position.
 . Indicator lights: "ON" / "HEATING" / "ERROR".

- Open cupboard :

. Open cupboard GN 1/1, rounded corners in the lower part and removable ladders.

Natural gas flow
G20/20 :

Propane gas flow
G31/37 :

CODE	DIMENSIONS	CAPACITY	POWER SUPPLY	POWER	WEIGHT
GMC0237	450 x 1000 x 900 mm	-	electricity 3-400 V + N + E	ELEC 5 kW	- Kg

OPTIONS	CODE
Hinged doors - for pass-through GN 2/1 cupboard	GMC0149
Pass-through GN 1/1 hot cupboard - rated 1,2 kW	N.A
1 electric socket 1~230V + E	GMC0117
-	-
-	-
-	-
-	-
-	-
-	-
-	-

ACCESSORIES	CODE
Top extension kit - for a central cooking suite	GMC0075
Rear filler strip kit - for module installed against a wall	GMC0097
Joining kit for 2 modules - module assembly	GMC0074

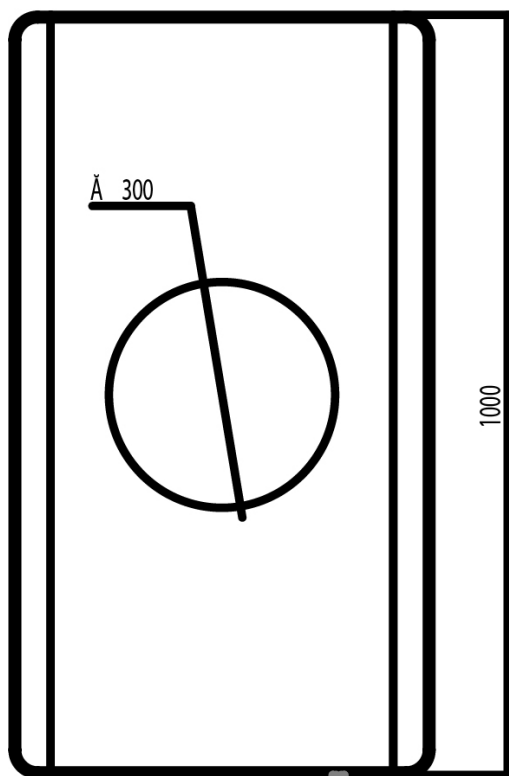
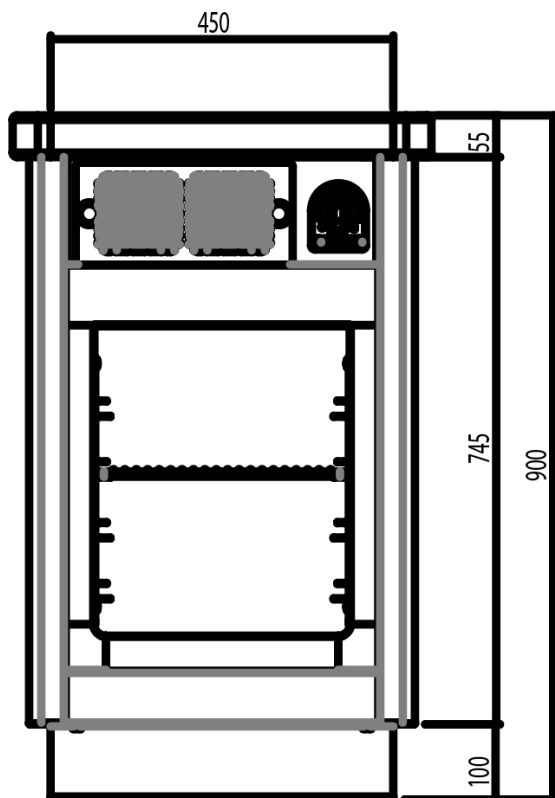

Technical characteristics are indicative only and can be modified from Charvet Co. without notice.

